



## MEMORY CARE FLOOR PLANS

Our family-oriented College Station community is located just minutes from everything, and offers a tranquil setting nestled among the trees. Our team embraces a proactive approach to the health and wellness of our residents and with our "resident first" philosophy, we are able to ensure quality of life through activities, home cooked meals and compassionate care.

Each private suite includes a bathroom and A/C unit. Our rates include three home-cooked meals, housekeeping, laundry, linens, utilities, activities, basic assistance with activities of daily living, and the availability of our trained care associates 24 hours a day.

### ADDITIONAL FEES:

- Incontinence Care supplies (optional): \$175 / month
- Second person fee: \$1,700 / month
- Memory Care Plus starting at: \$400 / month
- Respite Rate: \$250 / night

\* One time community fee of \$2,000 required  
*Rates subject to change.*

### SHARED

Separate Bedroom | Shared Bath  
All inclusive rate starts at \$5,100\* / month  
Approximately 425 total square feet

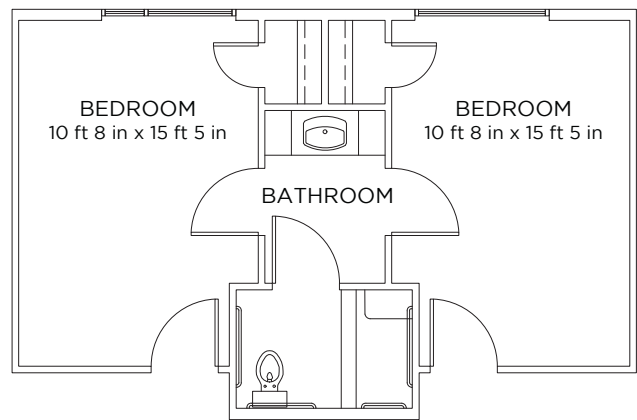

### PRIVATE

All inclusive rate starts at \$6,100\* / month  
Approximately 260 square feet

