

Engaged living, a tranquil setting, and compassionate care are hallmarks of Sodalis Flower Mound, a community that encourages an active lifestyle and daily activities for residents, both on campus and throughout the beautiful Flower Mound area. With designer touches throughout, you'll enjoy a spacious apartment home and a list of amenities, knowing that you have a full range of personalized care available.

FLOOR PLANS

STUDIO

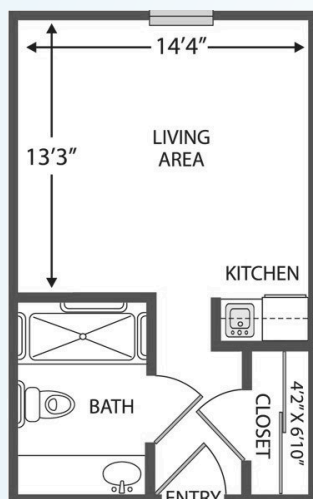

Bedroom / Living Room
Kitchenette | Bath
Starts at \$3,299* / month
350 square feet

STUDIO DELUXE

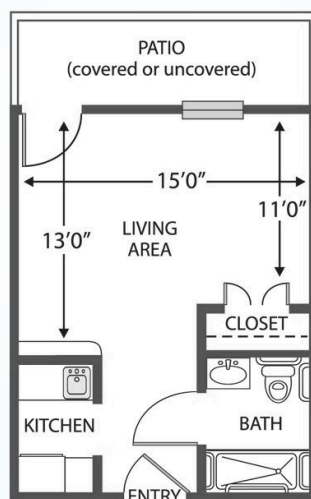

Bedroom / Living Room
Kitchenette | Bath | Patio
Starts at \$3,499* / month
370 square feet

TWO BEDROOM

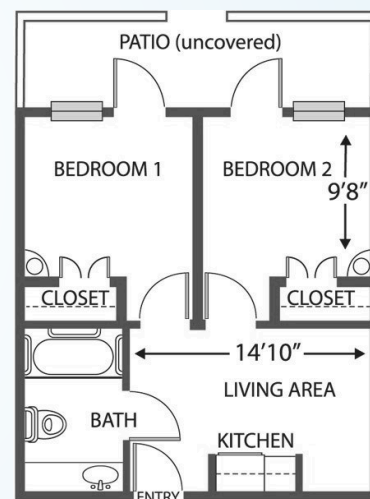

Living Room | 2 Bedrooms
Kitchenette | Bath | Patio
Starts at \$5,299* / month
525 square feet

ADDITIONAL FEES

- Companion Fee - Studio: \$2,400 (plus Care Fee)
- Companion Fee - Two Bedroom: \$2,700 (plus Care Fee)
- Second Person Fee: \$1,000 (plus Care Fee)
- Respite Rate: \$199 / day
- Community Fee: \$2,000 (one-time, non-refundable)
- Non-House Pharmacy Fee: \$175 / month
- Pet Fee**/Scooter Fee: \$500 (one-time)

* For residents who require assistance beyond our basic services, Sodalis Flower Mound uses a needs assessment tool to determine a resident's level of care upon admission. Level of care is not included in rent rate. Rates are subject to change.

** Small approved pets are allowed provided the resident can care for it and it is contained on a leash when out of their apartment.