



# SODALIS FLOWER MOUND

Engaged living, a tranquil setting, and compassionate care are hallmarks of Sodalis Flower Mound, a community that encourages an active lifestyle and daily activities for residents, both on campus and throughout the beautiful Flower Mound area. With designer touches throughout, you'll enjoy a spacious apartment home and a list of amenities, knowing that you have a full range of personalized care available.

## FLOOR PLANS

### STUDIO

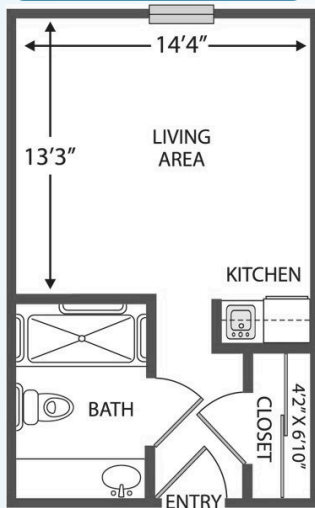

Bedroom / Living Room  
Kitchenette | Bath  
Starts at \$2,999\* / month  
350 square feet

### DELUXE STUDIO

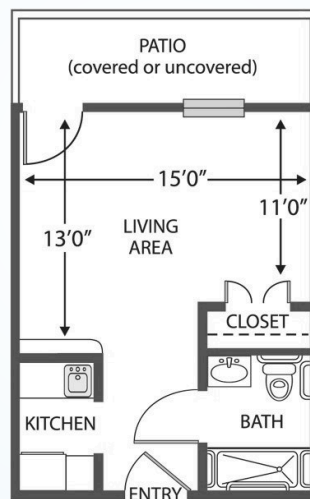

Bedroom / Living Room  
Kitchenette | Bath | Patio  
Starts at \$3,145\* / month  
370 square feet

### TWO BEDROOM

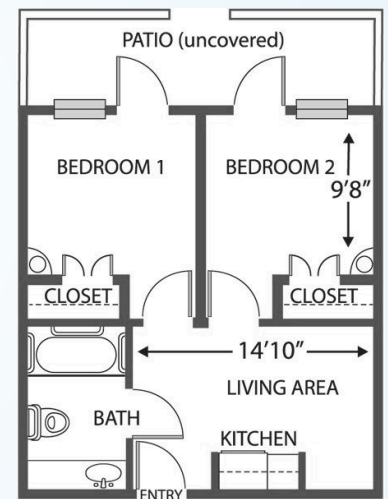

Living Room | 2 Bedrooms  
Kitchenette | Bath | Patio  
Starts at \$3,990\* / month  
525 square feet

## ADDITIONAL FEES

### Levels of Care\*:

- Level 1: \$500 / month
- Level 2: \$800 / month
- Level 3: \$1,000 / month
- Level 4: \$1,200 / month
- Level 5: \$1,400 / month

- Companion Fee: \$2,400 (plus Care Fee)
- Second Person Fee: \$1,000 (plus Care Fee)
- Respite Rate: \$150 / day
- Community Fee: \$2,000 (one-time, non-refundable)
- Non-House Pharmacy Fee: \$175 / month
- Pet Fee\*\*/Scooter Fee: \$500 (one-time)

\* For residents who require assistance beyond our basic services, Sodalis Flower Mound uses a needs assessment tool to determine a resident's level of care upon admission.

\*\* Small approved pets are allowed provided the resident can care for it and it is contained on a leash when out of their apartment.

Rates are subject to change.