

Engaged living, a tranquil setting, and compassionate care are hallmarks of Sodalis Austin, a community that encourages an active lifestyle and daily activities for residents, both on campus and throughout the beautiful Austin area. With designer touches throughout, you'll enjoy a spacious apartment home and a list of amenities, knowing that you have a full range of personalized care available.

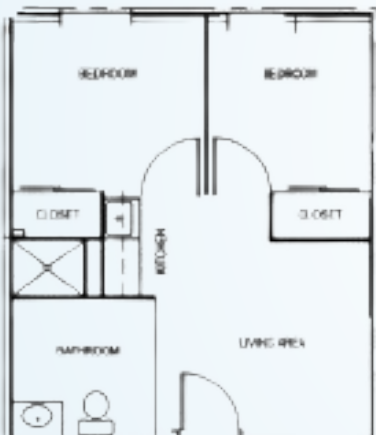

## ASSISTED LIVING FLOOR PLANS

### TWO BEDROOM



Living Room | 2 Bedrooms  
Kitchenette | Bath  
Starts at \$4,999\* / month  
460 square feet

### ONE BEDROOM



Living Room | 1 Bedroom  
Kitchenette | Bath  
Starts at \$3,999\* / month  
435 square feet

### STUDIO



Bedroom / Living Room  
Kitchenette | Bath  
Starts at \$2,999\* / month  
299 square feet

## ADDITIONAL FEES

- Community Fee: \$2,000 (one-time, non-refundable)
- Companion Fee: \$2,400 (plus Care Fee)
- Second Person Fee: \$1,000 (plus Care Fee)
- Respite Rate: \$199 / day
- Non-House Pharmacy Fee: \$175 / month
- Pet Fee\*\*/Scooter Fee: \$500 (one-time)

\* For residents who require assistance beyond our basic services, Sodalis Austin uses a needs assessment tool to determine a resident's level of care upon admission. Level of Care is not included in monthly rates. Rates are subject to change.

\*\* Small approved pets are allowed provided the resident can care for it and it is contained on a leash when out of their apartment.